

# Beam House Room Assignment Sheet

**Total Beds: 12**

**Beds are made on arrival, towels provided in these**

**1st. Floor: 1 bathroom equipped with handicapped shower.**

Room 1: Two twin beds, sink in room

1. \_\_\_\_\_

2. \_\_\_\_\_

Room 2: One double bed and two twin beds sink in room

1. \_\_\_\_\_

3. \_\_\_\_\_

2. \_\_\_\_\_

**Downstairs: 2 bathrooms: 1 with shower, 1 with tub-shower**

Room 3: One double bed and two twin beds

1. \_\_\_\_\_

3. \_\_\_\_\_

2. \_\_\_\_\_

Room 4: Two twin beds, sink in room

1. \_\_\_\_\_

2. \_\_\_\_\_

Room 5: One double bed and one twin bed, sink in room

1. \_\_\_\_\_

2. \_\_\_\_\_

**Main Floor**

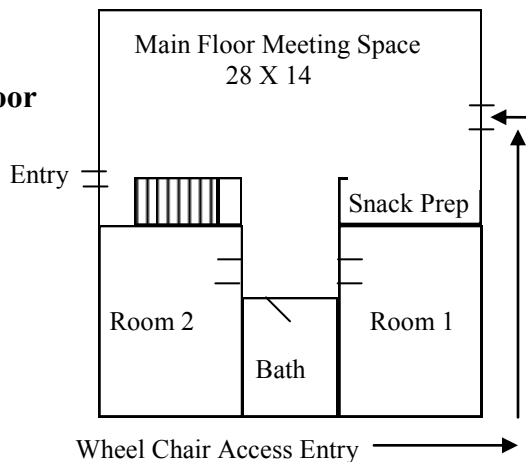

Lower Exit

